

1300 EAST CONSTRUCTION TRAFFIC IMPACTS

OCTOBER 2, 2019

Traffic Alerts:

Crews have completed communication duct bank work in the 1700 South/1300 East intersection, and will resume working in that intersection on storm drain installation and intersection improvements on Friday, October 4. We are slightly adjusting traffic control plans and detour routes that have been in place to accommodate work in the 1700 South/1300 East intersection. Please pay attention to the following traffic control facets:

- **West-bound movements THROUGH THE 1300 East/1700 South INTERSECTION will be closed again beginning Friday, October 4.** West-bound movements down 1700 South from Westminster college will continue as usual. West-bound motorists on 1700 South prior to 1300 East will need to detour north on **1500 East, west on 1300 South, and then south on 1100 East to get back to west-bound 1700 South.** (See map.) This detour is expected to be in place up to four weeks, though **traffic patterns are subject to change as work progresses.** Resident access will be maintained during this work. Motorists should expect steel plates in and near this intersection while these work activities take place.
- There is a soft-closure in place on southbound 1300 East at 1300 South. This soft-closure is only intended to deter motorists from driving southbound on 1300 East, only to get to 1700 South and be forced to either head east or try to turn around.

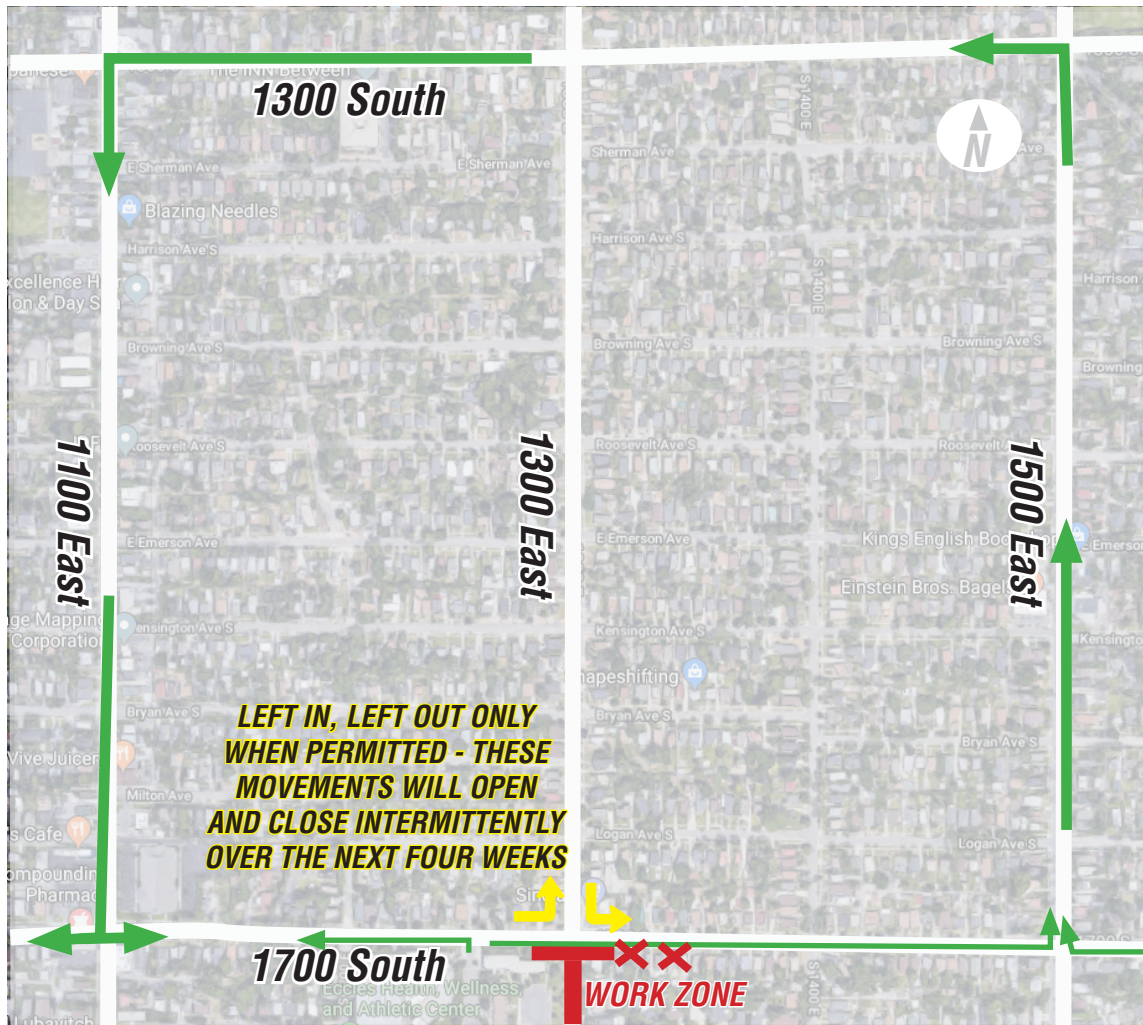

NO CONSTRUCTION WORK WILL TAKE PLACE ON 1300 EAST BETWEEN 1700 SOUTH AND 1300 SOUTH. All residents in that segment may continue to access their homes as normal.

- Motorists are reminded to watch out for trucks entering and leaving the work zone. Please make eye contact with operators before passing any equipment. This will help ensure that you are safe and clear to pass. Also, please mind the flaggers that are assisting with the safe flow of traffic.

Contact Us

Email: 1300east@slcgov.com | Hotline: 801-483-6898

Website: www.slc.gov/mystreet/1300east

**Schedule is subject to change due to weather or unforeseen circumstances.*



1300 EAST
RECONSTRUCTION

